

## C Series

High Voltage  
Lead Assemblies  
and Receptacles

## GENERAL SPECIFICATIONS For Limited Military/Aerospace Applications

### C Series Lead Assemblies and Receptacles

In 1997, Reynolds Industries, Inc. acquired the RLA series and other connector product lines from Rowe Industries, Inc. The RLA series has been renamed C series

C series high voltage lead assemblies and receptacles are widely used in CRT displays, ECM equipment, power supplies, Radar and almost any application where high voltage components need to be interconnected. The plug end is molded onto a desired length of silicone cable and can be ordered Single-Ended, Double-Ended or with shielding.

C series assemblies operate at voltages ranging from 10 KVDC to 50 KVDC and are interchangeable with Reynolds series 700 connectors and the LGH series. C series lead assemblies will operate up to 70,000 ft. and over a temperature range of -55°C to +95°C.

#### Interface cleaning

High voltage connectors must always be cleaned prior to mating. The proper cleaning method is to wipe or spray the interface area with isopropyl alcohol and immediately blow an inert gas such as dry nitrogen over the interface area until dry. No other cleaning method should be attempted.

**WARNING:** These connectors should **NEVER** be handled, mated or unmated when voltage is applied.

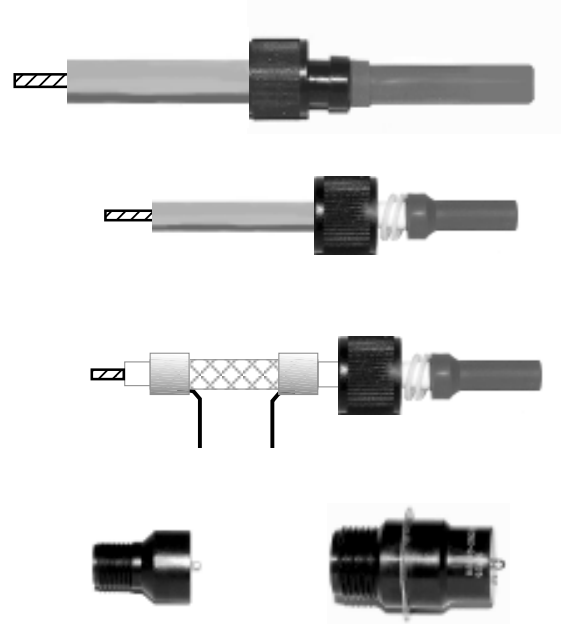

## GENERAL SPECIFICATIONS

Operating voltage

Altitude rating

Operating temperature

Insulator material

Coupling

Cable

Cable diameter

Mates Reynolds 700 series

Mates LGH I\* series

### Lead Assemblies

**10 -50 KVDC**

**Sea level to 70,000 ft.**

**-55°C to +95°C**

**Silicone Rubber**

**Threaded**

**Silicone rubber**

**0.160" to 0.385"**

**730, 737, 720 & 727**

**LGH 1/2I to LGH 4I**

### Receptacles

**10 -50 KVDC**

**Sea level to 70,000 ft.**

**-55°C to +95°C**

**Glass/Epoxy or DAP**

**Threaded**

**N/A**

**N/A**

**730, 737, 720 & 727**

**LGH 1/2I to LGH 4I**

Cable Assembly  
Length vs Manufacturing  
Tolerance Chart

**Length: feet/M**  
7.5/2.28 or less  
7.5/2.2 to 12.5/3.8  
12.5/3.8 to 22.5/6.8  
22.5/6.8 to 35/10.6  
35/10.6 to 50/15.2  
50/15.2 to 70/21.3  
70/21.3 to 100/30.4

**Tolerance: inches/mm**  
0.25/6.3  
1.0/25.4  
1.50/38.1  
2.0/50.8  
3.0/76.2  
4.0/101.6  
5.0/127

\*LGH is a trademark of AMP, Incorporated



## C 730 Series\*

**10 KVDC**  
High Voltage  
Lead Assemblies  
and Receptacles

Altitude Rated  
For Limited Military/Aerospace Applications  
**Operating Temperature:**  
-55°C to +95°C

### C 730 Series

### 10 KVDC Shielded & Non-Shielded Lead Assemblies

#### P/N 7RC1500 Positive Stop (ferrule)

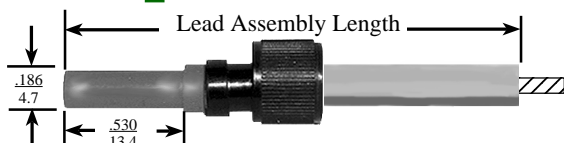

#### P/N RC1500 Non-Positive Stop (washers)

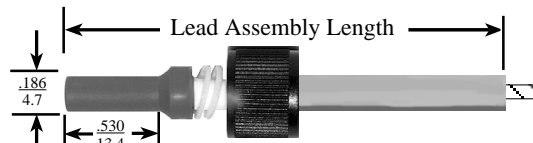

#### 17R1500 Positive Stop (ferrule)

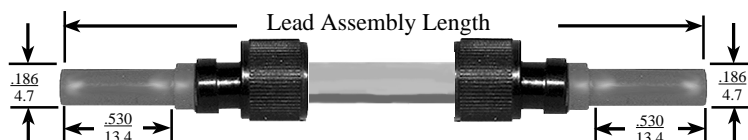

#### P/N 3R1500 Non-Positive Stop (washers)

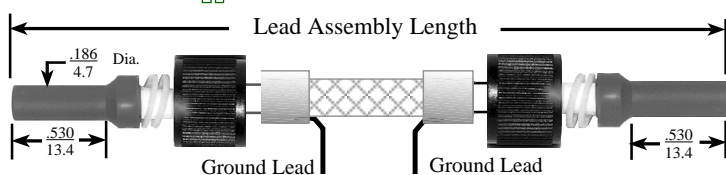

#### P/N 2RC1500 Non-Positive Stop (washers)

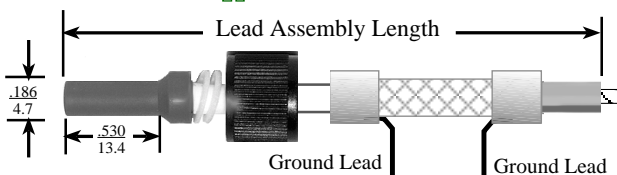

#### C 730 Series Functional Characteristics

Operating voltage: 10 KVDC any altitude to 70,000 ft. • Operating temperature: -55°C to +95°C  
Mating connectors: All C 730 series receptacles • All series 730 receptacles • All LGH 1/2I series receptacles.  
Wire type: White 0.160 Dia. silicone rubber. #AWG 16

#### Ordering Cable Assemblies

Use -XLX to specify cable assembly length:

X=feet L X=inches Example: 4L6 is 4 feet, 6 inches

**Note:** Stranded wire shown on single-ended assemblies is for factory testing and is not included in length dimension

### C 730 Series

### 10 KVDC Receptacles

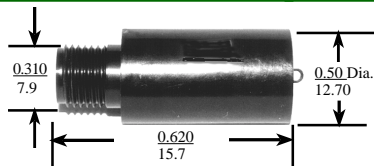

#### P/N RC1505

Operating voltage: 10 KVDC to 70,000 ft.  
Operating temperature: -55°C to +95°C  
Mating connectors:  
All C 730 lead assemblies  
All series 730 lead assemblies  
All LGH 1/2I lead assemblies

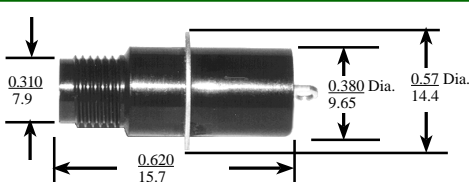

#### P/N 2RC1505

Operating voltage: 10 KVDC to 70,000 ft.  
Operating temperature: -55°C to +95°C  
Mating connectors:  
All C 730 lead assemblies  
All series 730 lead assemblies  
All LGH 1/2I lead assemblies  
Solder flange: Brass with tin plate

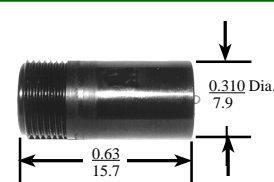

#### P/N 3RC1505

Operating voltage: 10 KVDC to 70,000 ft.  
Operating temperature: -55°C to +95°C  
Mating connectors:  
All C 730 lead assemblies  
All series 730 lead assemblies  
All LGH 1/2I lead assemblies

Test Voltage: 15 KVDC  
Lead Assemblies and Receptacles  
are 100% tested at sea level.

\* In 1997, Reynolds Industries, Inc. acquired the RLA 1500 and 1505 Series as depicted above from Rowe Industries, Inc. The RLA Series has been re-named C Series and retains its functional design.



## C 737 Series\*

### 15 KVDC

High Voltage  
Lead Assemblies  
and Receptacles

Altitude Rated  
For Limited Military/Aerospace Applications  
**Operating Temperature:**  
-55°C to +95°C

## C 737 Series

### 15 KVDC Shielded & Non-Shielded Lead Assemblies

#### P/N 7RC1510 Positive Stop (ferrule)



#### P/N RC1510 Non-Positive Stop (washers)



#### P/N 17R1510 Positive Stop (ferrule)



#### P/N 2RC1510 Non-Positive stop (washers)

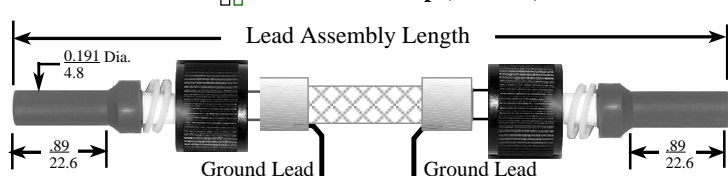

#### P/N 178-6092 Non-Positive Stop (washers)

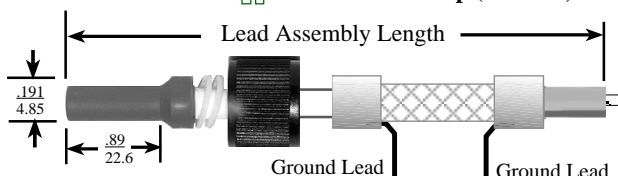

### C 737 Series Functional Characteristics

Operating voltage: 15 KVDC any altitude to 70,000 ft. • Operating Temperature: -55°C to +95°C

Mating connectors: All C 737 series receptacles • All series 737 receptacles • All LGH 1/2LI series receptacles

Cable type: White 0.160 Dia. silicone rubber. #AWG 16

### Ordering Cable Assemblies

Use -XLX to specify cable assembly length:

X=feet L X=inches Example: 4L6 is 4 feet, 6 inches

**Note:** Stranded wire shown on single-ended assemblies is for factory testing and is not included in length dimension

## C 737 Series

### 15 KVDC Receptacles

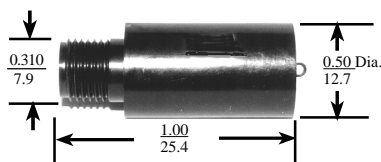

#### P/N RC1515

Operating voltage: 15 KVDC to 70,000 ft.

Operating temperature: -55°C to +95°C

Mating connectors:

- All C 737 lead assemblies
- All Series 737 lead assemblies
- All LGH 1/2LI lead assemblies

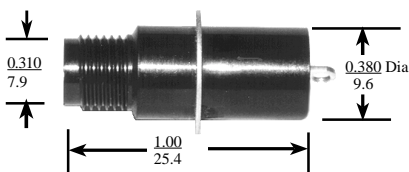

#### P/N 2RC1515

Operating voltage: 15 KVDC to 70,000 ft.

Operating temperature: -55°C to +95°C

Mating connectors:

- All C 730 lead assemblies
  - All series 737 lead assemblies
  - All LGH 1/2LI lead assemblies
- Solder flange: Brass with tin plate

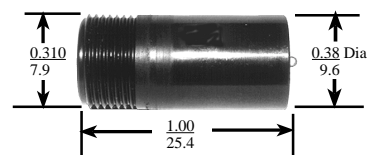

#### P/N 13RC1515

Operating voltage: 15 KVDC to 70,000 ft.

Operating temperature: -55°C to +95°C

Mating connectors:

- All C 730 lead assemblies
- All series 737 lead assemblies
- All LGH 1/2LI lead assemblies

Test Voltage: 18 KVDC  
Lead Assemblies and Receptacles  
are 100% tested at sea level.

\* In 1997, Reynolds Industries, Inc. acquired the RLA 1510 and 1515 Series as depicted above from Rowe Industries, Inc. The RLA Series has been re-named C Series and retains its functional design.





## C 720 Series\*

### 20 KVDC

High Voltage  
Lead Assemblies  
and Receptacles

Altitude Rated  
For Limited Military/Aerospace Applications  
**Operating Temperature:**  
-55°C to +95°C

## C 720 Series

## 20 KVDC Shielded & Non-Shielded Lead Assemblies

### P/N 21RC1520 Positive Stop (ferrule)

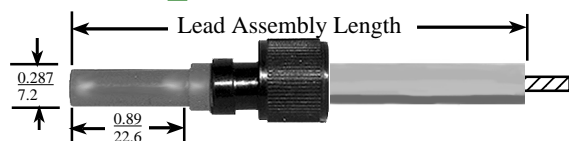

### P/N RC1520 Non-Positive Stop (washers)

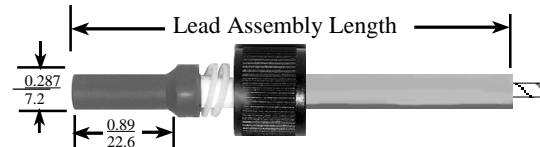

### P/N R1520 Non-Positive Stop (washers)

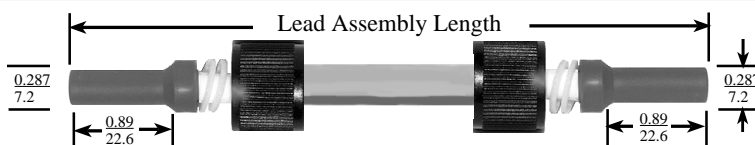

### P/N 178-6093 Non-Positive Stop (washers)

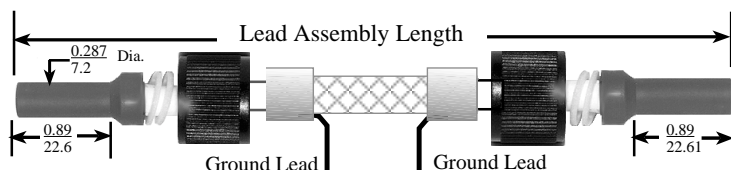

### P/N 178-6094 Non-Positive Stop (washers)

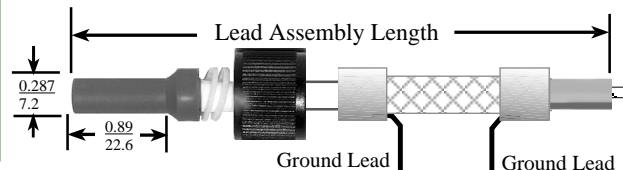

### C 720 Series Functional Characteristics

Operating voltage: 20 KVDC any altitude to 70,000 ft. • Operating Temperature: -55°C to +95°C  
Mating connectors: All C 720 series receptacles • All series 720 receptacles • All LGH LI series receptacles  
Cable type: White 0.265 Dia. silicone rubber. #AWG 16

### Ordering Cable Assemblies

Use -XLX to specify cable assembly length:  
X=feet L X=inches Example: 4L6 is 4 feet, 6 inches

**Note:** Stranded wire shown on single-ended assemblies is for factory testing and is not included in length dimension

## C 720 Series

## 20 KVDC Receptacles

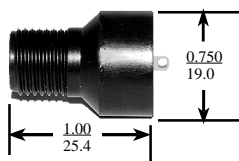

### P/N RC1525

Operating voltage: 20 KVDC to 70,000 ft.  
Operating temperature: -55°C to +95°C  
Mating connectors:  
All C 720 1520 Lead assemblies  
All LGH II series lead assemblies  
All series 720 lead assemblies

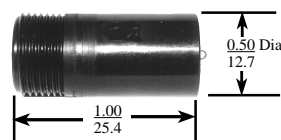

### P/N 3RC1525

Operating voltage: 20 KVDC to 70,000 ft.  
Operating temperature: -55°C to +95°C  
Mating connectors:  
All C 720 1520 lead assemblies  
All LGH II series lead assemblies  
All series 720 lead assemblies

Test Voltage: 25 KVDC  
Lead Assemblies and Receptacles  
are 100% tested at sea level.

\* In 1997, Reynolds Industries, Inc. acquired the RLA 1520 and 1525 Series as depicted above from Rowe Industries, Inc. The RLA Series has been re-named C Series and retains its functional design.



## C 727 Series\*

### 25 KVDC

High Voltage  
Lead Assemblies  
and Receptacles

Altitude Rated  
For Limited Military/Aerospace Applications

Operating Temperature:  
-55°C to +95°C

## C 727 Series

### 25 KVDC Shielded & Non-Shielded Lead Assemblies

#### P/N RC1530 Non-Positive Stop (washers)



#### P/N R1530 Non-Positive Stop (washers)

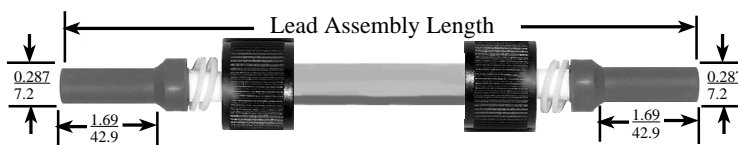

#### P/N 2R1530 Non-Positive Stop (washers)

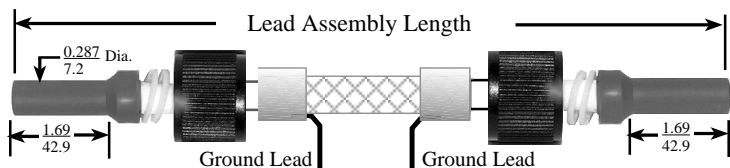

#### P/N 2RC1530 Non-positive stop (washers)

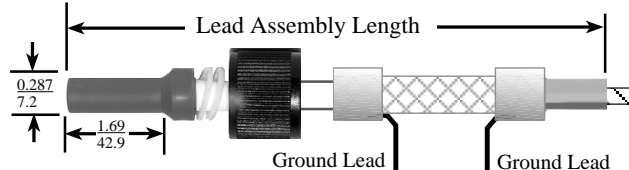

#### C 727 Series Functional Characteristics

Operating voltage: 25 KVDC. Any Altitude to 70,000 ft. • Operating temperature: -55°C to 95°C  
Mating connectors: All C 727 series receptacles • All series 727 receptacles • All LGH 1LI series receptacles  
Cable type: White 0.300 Dia. silicone rubber. #AWG 16

#### Ordering Cable Assemblies

Use -XLX to specify cable assembly length:

X=feet L X=inches Example: 4L6 is 4 feet, 6 inches

**Note:** Stranded wire shown on single-ended assemblies is for factory testing and is not included in length dimension

## C 727 Series

### 25 KVDC Receptacles

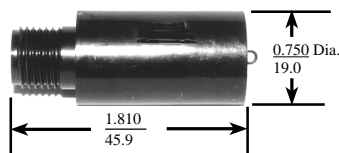

#### P/N RC1535

Operating voltage: 25 KVDC to 70,000 ft.

Operating temperature: -55°C to +95°C

Mating connectors:

All C 727 series lead assemblies

All Series 727 lead assemblies

All LGH 1LI series lead assemblies

Test Voltage: 35 KVDC  
Lead Assemblies and Receptacles  
are 100% tested at sea level.

\* In 1997, Reynolds Industries, Inc. acquired the RLA 1530 and 1535 Series as depicted above from Rowe Industries, Inc. The RLA Series has been re-named C Series and retains its functional design.



## C 735 Series\*

### 30 KVDC

High Voltage  
Lead Assemblies  
and Receptacles

Altitude Rated  
For Limited Military/Aerospace Applications  
**Operating Temperature:**  
-55°C to +95°C

## C 735 Series

### 30 KVDC Shielded & Non-Shielded Lead Assemblies

#### P/N RC1540 Non-Positive Stop (washers)

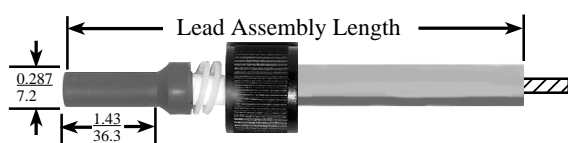

#### P/N R1540 Non-Positive Stop (washers)

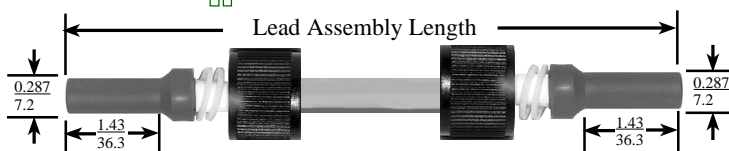

#### P/N 2RC1540 Non-Positive Stop (washers)

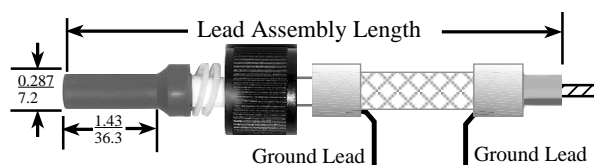

#### P/N 2R1540 Non-Positive Stop (washers)

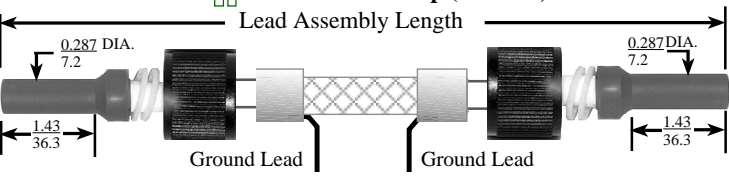

### C 735 Series Functional Characteristics

Operating voltage: 30 KVDC any altitude to 70,000 ft. • Operating temperature: -55°C to +95°C

Mating connectors: All C 735 series receptacles

Cable type: White .300 Dia. silicone rubber. # AWG 16

### Ordering Cable Assemblies

Use -XLX to specify cable assembly length:

X=feet L X=inches Example: 4L6 is 4 feet, 6 inches

**Note:** Stranded wire shown on single-ended assemblies is for factory testing and is not included in length dimension

## C 735 Series

### 30 KVDC Receptacles

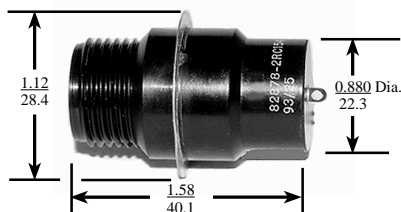

#### P/N 2RC1545

Operating voltage: 30 KVDC to 70,000 ft.

Operating temperature: -55°C to +95°C

Mating connectors:

All C 735 series lead assemblies

Solder flange: Brass with tin plate

Test Voltage: 45 KVDC  
Lead Assemblies and Receptacles  
are 100% tested at sea level.

\* In 1997, Reynolds Industries, Inc. acquired the RLA 1540 and 1545 Series as depicted above from Rowe Industries, Inc. The RLA Series has been re-named C Series and retains its functional design.





## C 740 Series\*

### 40 KVDC

High Voltage  
Lead Assemblies  
and Receptacles

Altitude Rated  
For Limited Military/Aerospace Applications  
**Operating Temperature:**  
-55°C to +95°C

## C 740 Series

### 40 KVDC Shielded & Non-Shielded Lead Assemblies

#### P/N RC1550 Non-Positive Stop (washers)



#### P/N 3R1550 Non-Positive Stop (washers)

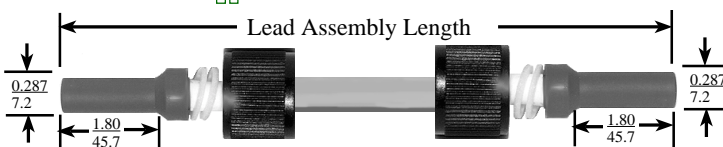

#### P/N 3RC1550 Non-Positive Stop (washers)

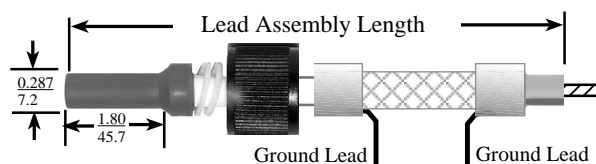

#### P/N 4R1550 Non-Positive Stop (washers)

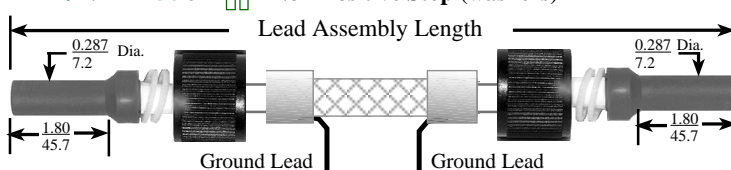

### C 740 Series Functional Characteristics

Operating voltage: 40 KVDC any altitude to 70,000 ft. • Operating temperature: -55°C to +95°C

Mating connectors: All C 740 series receptacles • All LGH 3I series receptacles

Cable type: White .300 Dia. silicone rubber # AWG 16

### Ordering Cable Assemblies

Use -XLX to specify cable assembly length:

X=feet L X=inches Example: 4L6 is 4 feet, 6 inches

**Note:** Stranded wire shown on single-ended assemblies is for factory testing and is not included in length dimension

## C 740 Series

### 40 KVDC Receptacles

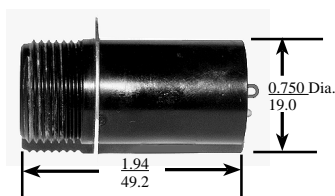

#### P/N 178-6090

Operating voltage: 40 KVDC to 70,000 ft.

Operating temperature: -55°C to +95°C

Mating connectors:

All C 740 lead assemblies

All LGH 3I series lead assemblies

Solder flange: Brass with tin plate

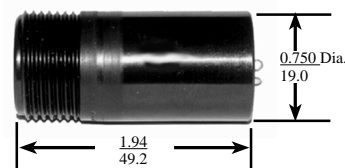

#### P/N RC1545

Operating voltage: 40 KVDC to 70,000 ft.

Operating temperature: -55°C to +95°C

Mating connectors:

All C 740 lead assemblies

All LGH 3I series lead assemblies

Test Voltage: 50 KVDC  
Lead Assemblies and Receptacles  
are 100% tested at sea level.

\* In 1997, Reynolds Industries, Inc. acquired the RLA 1550 and 1555 Series as depicted above from Rowe Industries, Inc. The RLA Series has been re-named C Series and retains its functional design.



## C 750 Series\*

### 50 KVDC

High Voltage  
Lead Assemblies  
and Receptacles

Altitude Rated  
For Limited Military/Aerospace Applications  
**Operating Temperature:**  
-55°C to +95°C

## C 750 Series

### 50 KVDC Shielded & Non-Shielded Lead Assemblies

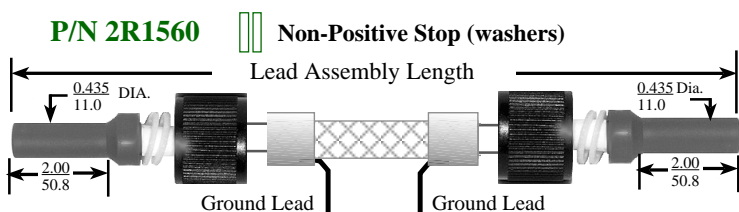
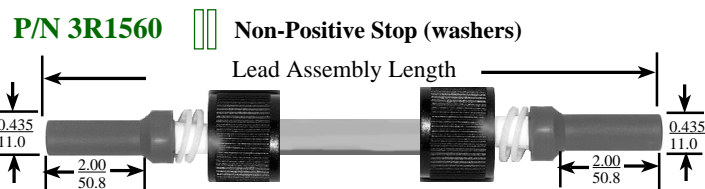

### C 750 Series Functional Characteristics

Operating voltage: 50 KVDC any altitude to 70,000 ft. • Operating Temperature: -55°C to +95°C

Mating connectors: All C 750 series receptacles • All LGH 4I series receptacles

Cable type: White .385 Dia. silicone rubber. # AWG 14

### Ordering Cable Assemblies

Use -XLX to specify cable assembly length:

X=feet L X=inches Example: 4L6 is 4 feet, 6 inches

**Note:** Stranded wire shown on single-ended assemblies is for factory testing and is not included in length dimension

## C 750 Series

### 50 KVDC Receptacles

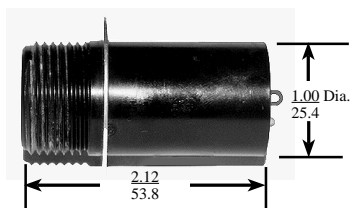

### P/N 2RC1565

Operating voltage: 50 KVDC to 70,000 ft.

Operating temperature: -55°C to +95°C

Mating connectors:

All C 750 lead assemblies

All LGH 4I series lead assemblies

Solder flange: Brass with tin plate

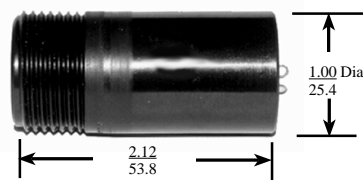

### P/N 10RC1565

Operating voltage: 50 KVDC to 70,000 ft.

Operating temperature: -55°C to +95°C

Mating connectors:

All C 750 lead assemblies

All LGH 4I series lead assemblies

Test voltage: 60 KVDC  
Lead Assemblies and Receptacles  
are 100% tested at sea level.

\* In 1997, Reynolds Industries, Inc. acquired the RLA 1560 and 1565 Series as depicted above from Rowe Industries, Inc. The RLA Series has been re-named C Series and retains its functional design.