

Supra-Con

Designed for highest power application in any RF industry up to over 100 kW – Dedicated for a wide frequency range from below 1 MHz up to over 40 MHz due to low self inductance – Surpassing new triplex-water-cooling allows industry water up to 6 bars without compromising the bellows – Improved and latest lead-free drive system for long lifetime over 1 million cycles – Mostly used in the semiconductor, display and solar technology.

Technical Features

Capacitance (Cmax)	250 pF to 5000 pF
Voltage (peak test)	10 kV to 60 kV
Current (rms max)	450 A
Diameter	183 mm
Overall length	295 mm
Inductance (@ Cmax)	≤ 15 nH

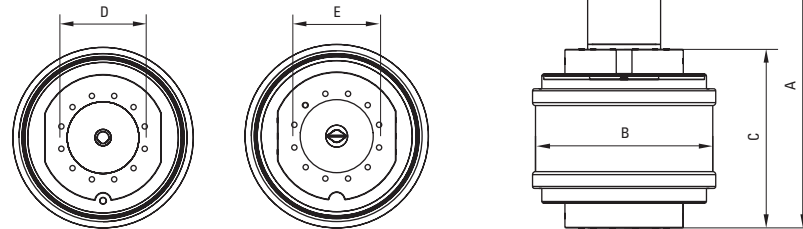

Product Overview

Capacitance		Voltage Upt kV	Current @13.56 MHz Arms	Inductance @Cmax nH	Cooling System	Mounting Dimensions in mm					Slope pF/Turn pF/mm	Max. Torque Nm	Pull Force N	Optional Features	Type Designation System	
Cmin pF	Cmax pF					A	B	C	D	E					Part No.	
25	250	60	450	≤ 15	W	295	183	187	∅ 88.9 12x M6	∅ 88.9 12x M6	9.4	0.8	–	–	CVSU-250AW/65-ADUD	
50	500	55	450	≤ 15	W	295	183	187	∅ 88.9 12x M6	∅ 88.9 12x M6	19.5	0.8	–	–	CVSU-500AW/55-ADUD	
75	750	40	450	≤ 15	W	295	183	187	∅ 88.9 12x M6	∅ 88.9 12x M6	28.3	0.8	–	–	CVSU-750AW/40-ADUD	
100	1000	25	450	≤ 15	W	295	183	187	∅ 88.9 12x M6	∅ 88.9 12x M6	37.6	0.8	–	–	CVSU-1000AW/25-ADUD	
200	2000	25	450	≤ 15	W	295	183	187	∅ 88.9 12x M6	∅ 88.9 12x M6	75.4	0.8	–	–	CVSU-2000AW/25-ADUD	
250	2500	20	450	≤ 15	W	295	183	187	∅ 88.9 12x M6	∅ 88.9 12x M6	97.8	0.8	–	–	CVSU-2500AW/20-ADUD	
300	3000	15	450	≤ 15	W	295	183	187	∅ 88.9 12x M6	∅ 88.9 12x M6	111.1	0.8	–	–	CVSU-3000AW/15-ADUD	
500	5000	10	450	≤ 15	W	295	183	187	∅ 88.9 12x M6	∅ 88.9 12x M6	213.3	0.8	–	–	CVSU-5000AW/10-ADUD	

W: Water

The information above is not to be used for design purpose. For detailed information refer to the individual data sheet.