

| CONN. TYPE | DIM. A |
|------------|--------|
| SMA FEMALE | 3.36 |
| SMA MALE | 3.49 |

| REV | ECN | DATE | BY | APPR |
|-----|--------|----------|-----|------|
| - | ISSUED | 2-18-09 | TEZ | SMR |
| A | 15391 | 6-1-09 | BZ | SMR |
| B | 17381 | 7-6-09 | BZ | TEZ |
| C | 21251 | 2-14-12 | JZ | TRS |
| D | 22399 | 1-16-13 | JZ | TEZ |
| E | 23120 | 8-8-13 | JZ | TEZ |
| F | 24444 | 10-21-19 | GM | TEZ |



JFW INDUSTRIES, INC.

www.jfwindustries.com

PH: 317-887-1340

| | | |
|-------------|-----------------|--|
| MATERIAL | ALUMINUM ALLOY | PROPRIETARY INFORMATION |
| FINISH | BLACK ANODIZE | ALL SURFACES ARE TO BE FREE OF BURRS, PITS & SCRATCHES |
| MODEL | | TOLERANCES |
| | | .XX±.010 .XXX±.005 XX°±.5° |
| DESCRIPTION | 50W TERMINATION | DWG # |
| | | 092-5574 |

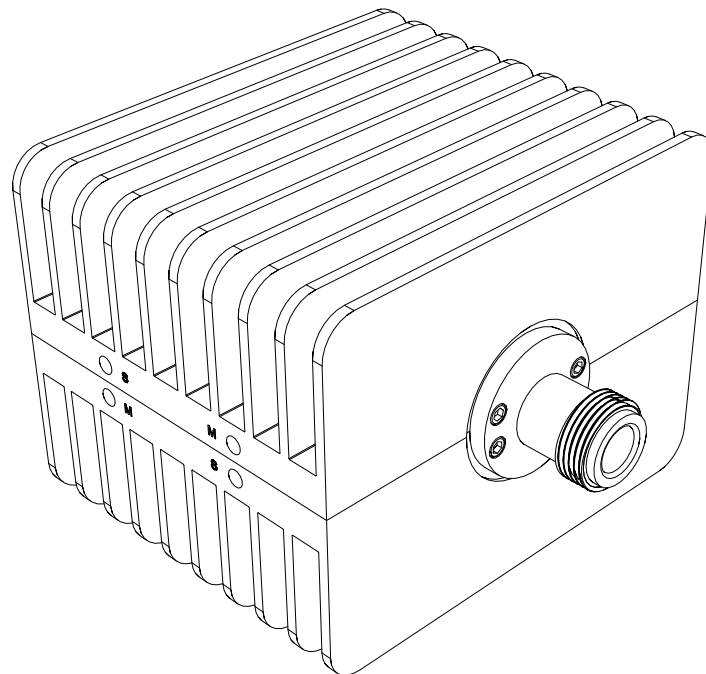
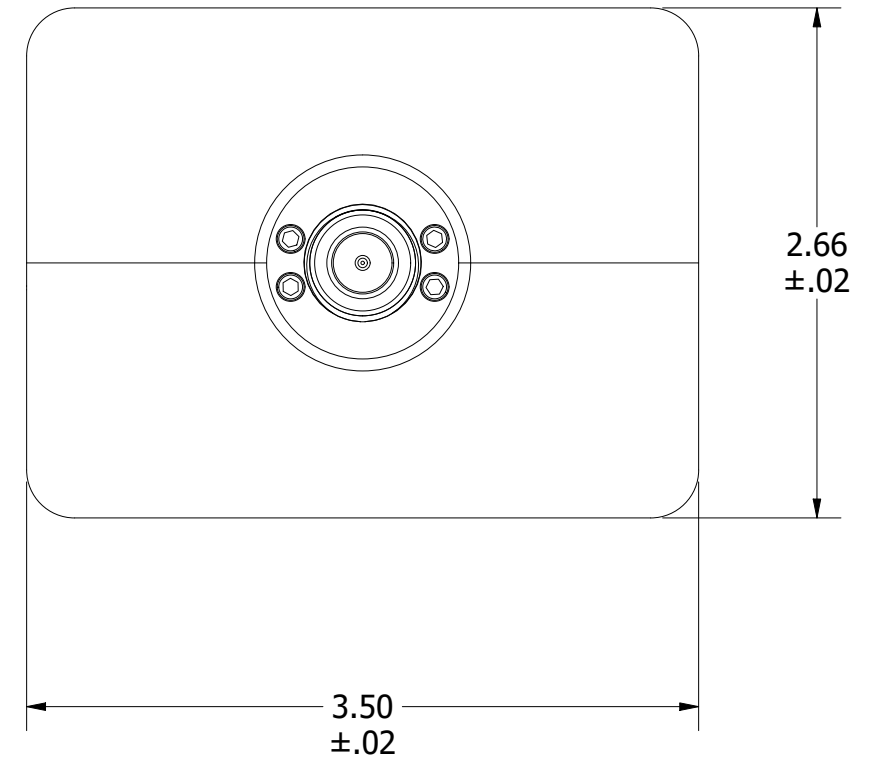
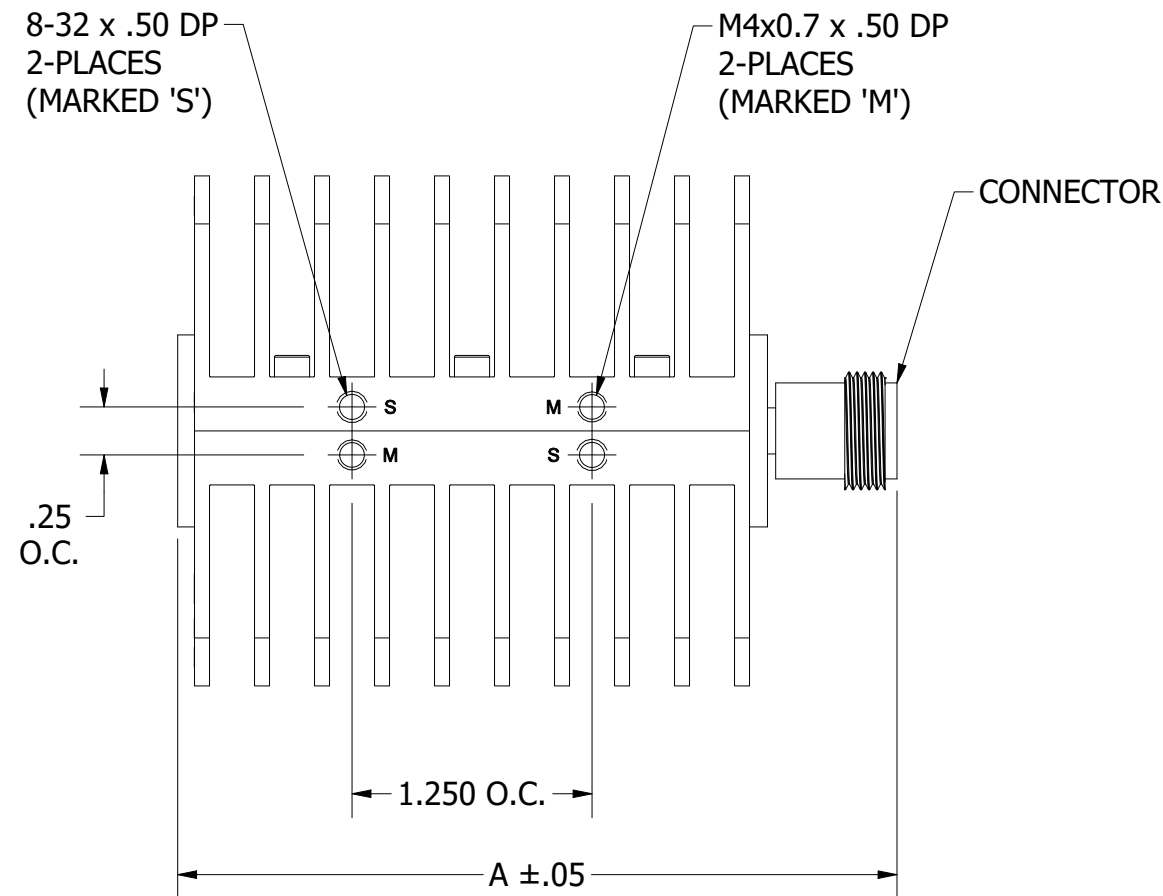
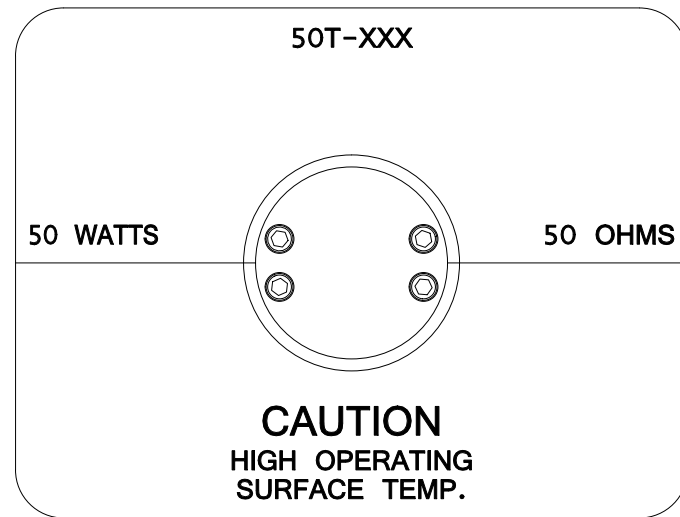

| CONN. TYPE | DIM. A |
|------------|--------|
| N FEMALE | 3.82 |
| N MALE | 3.74 |

| REV | ECN | DATE | BY | APPR |
|-----|--------|----------|----|------|
| - | ISSUED | 2-18-08 | BZ | TEZ |
| A | 21251 | 2-14-12 | JZ | TEZ |
| B | 22399 | 1-16-13 | JZ | TEZ |
| C | 23120 | 8-8-13 | JZ | TEZ |
| D | 24444 | 10-21-19 | GM | TEZ |



JFW INDUSTRIES, INC.

www.jfwindustries.com

PH: 317-887-1340

| | | |
|-------------|-----------------|--|
| MATERIAL | ALUMINUM ALLOY | PROPRIETARY INFORMATION |
| FINISH | BLACK ANODIZE | ALL SURFACES ARE TO BE FREE OF BURRS, PITS & SCRATCHES |
| MODEL | 50T-XXX | TOLERANCES .XX±.010 .XXX±.005 XX°±.5° |
| DESCRIPTION | 50W TERMINATION | DWG # 092-5725 |