

ALL DESIGN, OPERATIVE AND PROCESS DATA PERTAINING TO THE ARTICLE SHOWN ON THIS SHEET IS THE PROPERTY OF POLYPHASE CORPORATION. THE INFORMATION IS NOT TO BE COPIED, REPRODUCED, REVEALED TO OR APPROPRIATED BY OTHERS WITHOUT THE EXPRESS WRITTEN CONSENT OF POLYPHASE CORPORATION.

# REVISIONS

| REV LTR | DATE        | ENG | MKTG | Q.A. |
|---------|-------------|-----|------|------|
| E       | 12/06/04 SH | KCB | SD   | LJ   |

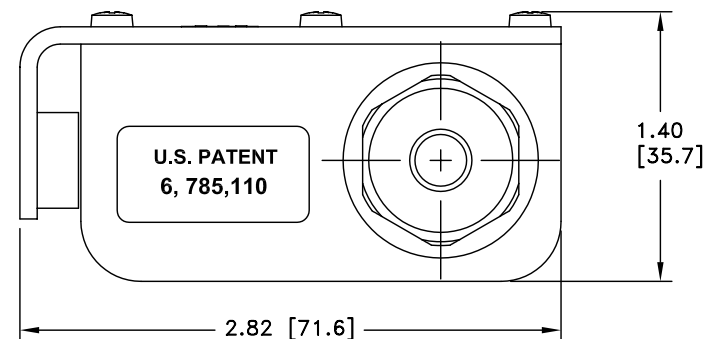
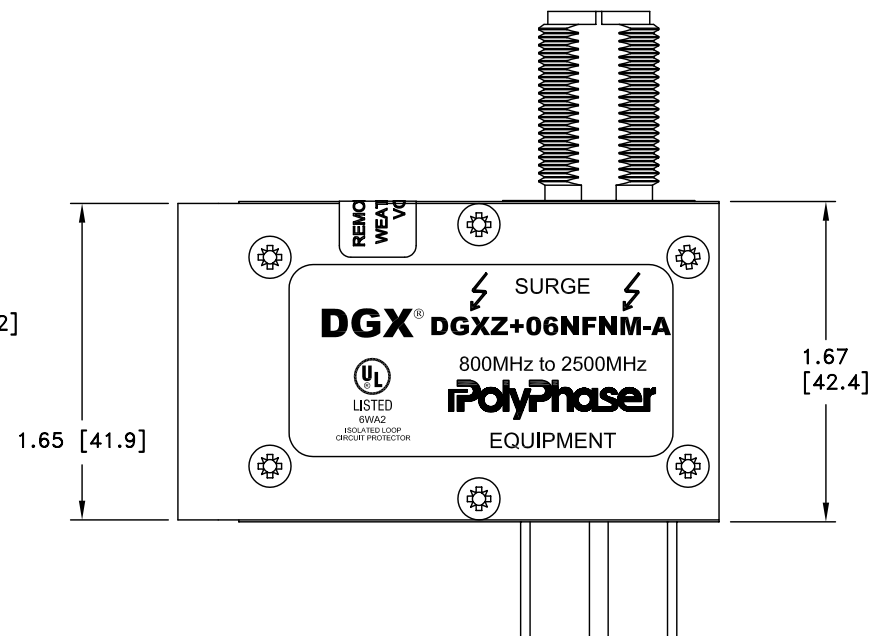
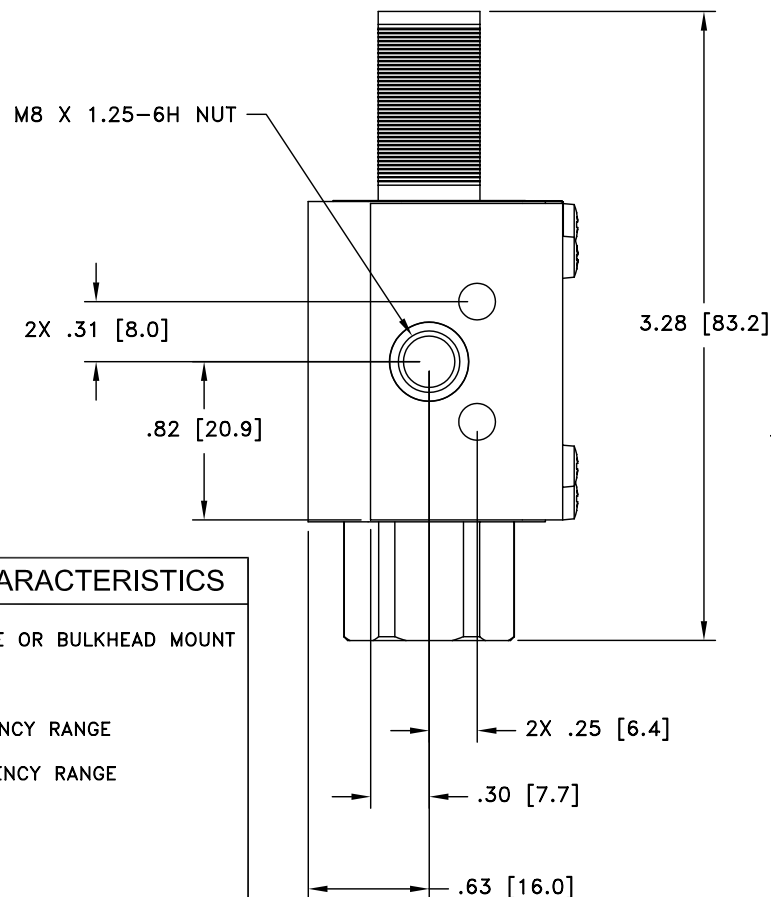

## MAXIMUM CHARACTERISTICS

APPLICATION:  
WEATHERIZED, FLANGE OR BULKHEAD MOUNT  
FREQUENCY RANGE:  
800MHz TO 2500MHz  
VSWR:  
≤1.1:1 OVER FREQUENCY RANGE  
INSERTION LOSS:  
≤0.1dB OVER FREQUENCY RANGE  
POWER:  
.25W RMS AVERAGE  
TURN ON:  
+6.5Vdc  
TURN ON TIME:  
4ns FOR 2kV/ns  
MAX. SURGE:  
20kA IEC 61000-4-5 8/20μs WAVEFORM  
THROUGHPUT ENERGY:  
≤175μJ FOR 3kA, 8/20μs WAVEFORM  
USER VOLTAGE:  
+6.0Vdc MAX  
USAGE CURRENT:  
≤4.0A CONTINUOUS  
RELATIVE HUMIDITY:  
TO 95%  
ENVIRONMENTAL:  
MEETS IEC 60529 IP67  
MEETS BELLCORE #TA-NWT-000487  
PROCEDURE 4.11, WIND DRIVEN (120MPH)  
RAIN INTRUSION TEST.  
TEMPERATURE:  
-50°C TO +85°C STORAGE/OPERATING

CUSTOMER APPROVAL: \_\_\_\_\_ DATE: \_\_\_\_\_

ALL DIMENSIONS SHOWN ABOVE ARE FOR REFERENCE ONLY.

|                              |                  |  |                  |              |
|------------------------------|------------------|--|------------------|--------------|
| DRAFTER<br>I. BENNETT        | DATE<br>03/21/02 | <br>P.O. BOX 9000 MINDEN, NV 89423 TEL: 775-782-2511 FAX: 775-782-4476<br>DWG NO/PART NO/DESCRIPTION<br>DGXZ+06NFM-A<br>CUSTOMER PRINT |                  |              |
| MECH ENGINEER<br>P. SKROTZKI | DATE<br>04/30/02 |  |                  |              |
| ELEC ENGINEER<br>K. BARTEL   | DATE<br>04/25/02 |  |                  |              |
| MARKETING<br>P. HEEREN       | DATE<br>04/29/02 |  |                  |              |
| QUALITY DEPT<br>R. MATHEUS   | DATE<br>04/26/02 | CAGE CODE<br>61114   | FILE NAME<br>-C1 | SCALE<br>1/1 |
|                              |                  | SHEET<br>1 OF 1  |                  |              |