

ALL DESIGN, OPERATIVE AND PROCESS DATA PERTAINING TO THE ARTICLE SHOWN ON THIS SHEET IS THE PROPERTY OF POLYPHASER CORPORATION. THE INFORMATION IS NOT TO BE COPIED, REPRODUCED, REVEALED TO OR APPROPRIATED BY OTHERS WITHOUT THE EXPRESS WRITTEN CONSENT OF POLYPHASER CORPORATION.

REVISIONS				
REV LTR	DATE	ENG	MKTG	Q.A.
A	07/15/99 <sub>SH</sub>	M.M	R.J	J.B
B	01/15/01 <sub>SH</sub>	KCB	PH	RM

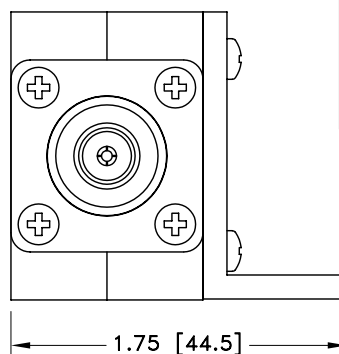
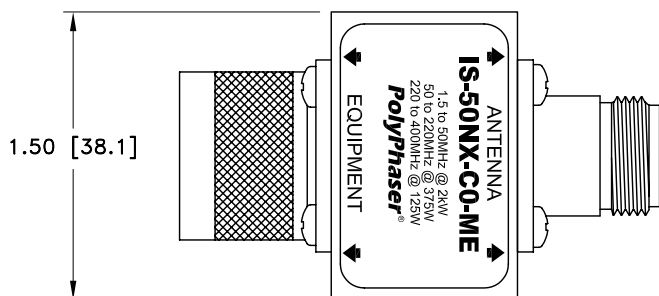
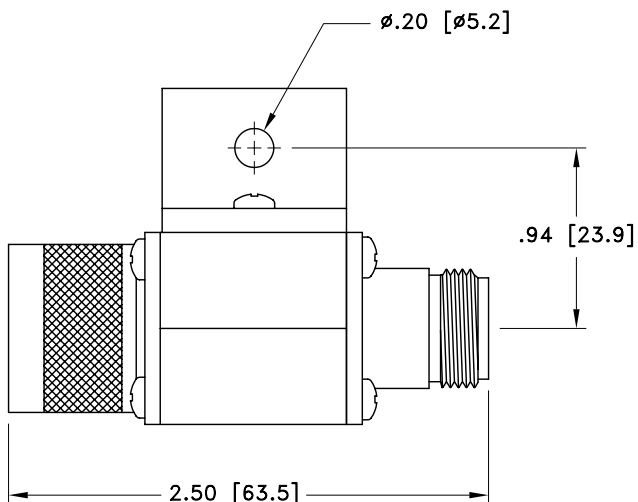

MAXIMUM CHARACTERISTICS	
APPLICATION: FLANGE MOUNT	
FREQUENCY RANGE: 1.5MHz TO 400MHz	
SURGE: 50kA IEC 1000-4-5 8/20μs WAVEFORM 500J	
TURN-ON: 600Vdc ±20% 2.5ns FOR 2kV/ns	
VSWR: ≤1.2 TO 1 @ 1.5 TO 2.0MHz ≤1.1 TO 1 @ 2 TO 400MHz	
INSERTION LOSS: ≤0.1dB OVER FREQUENCY RANGE	
MAX POWER: HF 2kW, VHF 375W, UHF 125W	
THROUGHPUT ENERGY: ≤10mJ TYPICAL	
OPERATING TEMPERATURE: +50°C	
STORAGE TEMPERATURE: -45°C TO +85°C	
RELATIVE HUMIDITY: 90% AT 40°C	
VIBRATION: 1G AT 5Hz TO 100Hz	

CUSTOMER APPROVAL: \_\_\_\_\_ DATE: \_\_\_\_\_

ALL DIMENSIONS SHOWN ABOVE ARE FOR REFERENCE ONLY.

DRAFTER J. CALLISTER	DATE 03/25/98	<b>PolyPhaser®</b> P.O. BOX 9000, MINDEN, NV 89423-9000 (775) 782-2511 FAX (775) 782-4476 DWG NO/PART NO/DESCRIPTION <b>IS-50NX-CO-ME</b> CUSTOMER PRINT		
MECH ENGINEER R. DUNNING	DATE 04/21/98			
ELEC ENGINEER K. BARTEL	DATE 04/17/98			
MARKETING R. MILLER	DATE 04/21/98			
QUALITY DEPT R. MILLER	DATE 04/21/98			
CAGE CODE 61114	FILE NAME -C1	SCALE 1/1	SHEET 1 OF 1	